

E7008 Euro-profile cylinder mortice night latch

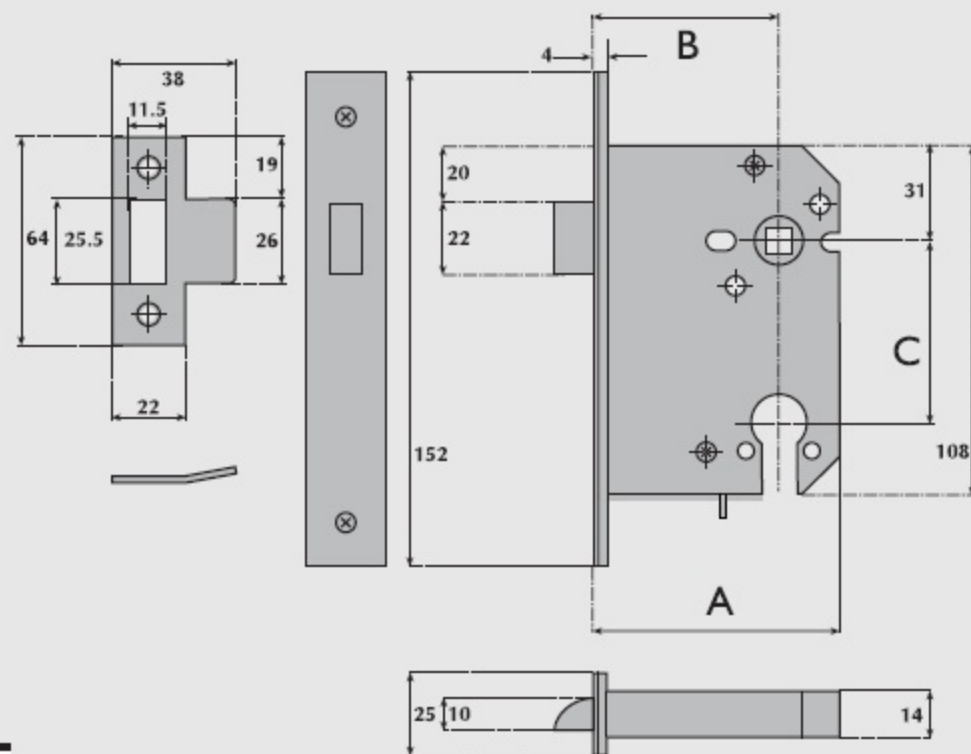

A Lockcase	B Backset	C Centres
76mm	57mm	57mm
101mm	82mm	57mm

OPERATION:

Latchbolt operated by key from outside and lever handle or turn knob from inside.

SPECIFICATION:

CASE.

Pierced to accept 20mm centre bolt through fixing escutcheons.
Pierced to accept 38mm centre horizontally and diagonally opposed bolt through fixing furniture.

STRIKE PLATE.

Type E.

LATCHBOLT.

Brass. Projection 12mm. Hand must be specified.

Also available with non-handed roller bolt.

FOLLOWER.

Brass, to suit 8mm square spindle. One-way action.

Sprung to suit sprung lever handle furniture.

For unsprung lever handle furniture heavy springing should be specified.

CYLINDER.

Not supplied. May be used with the following cylinder:

- Key outside such as Guardian G9000.
- Key either side such as Guardian G9001.

REBATE UNITS

TO SUIT:

G3051-13mm G3052-19mm G3053-25mm