

# G7058 Oval-profile cylinder mortice night latch

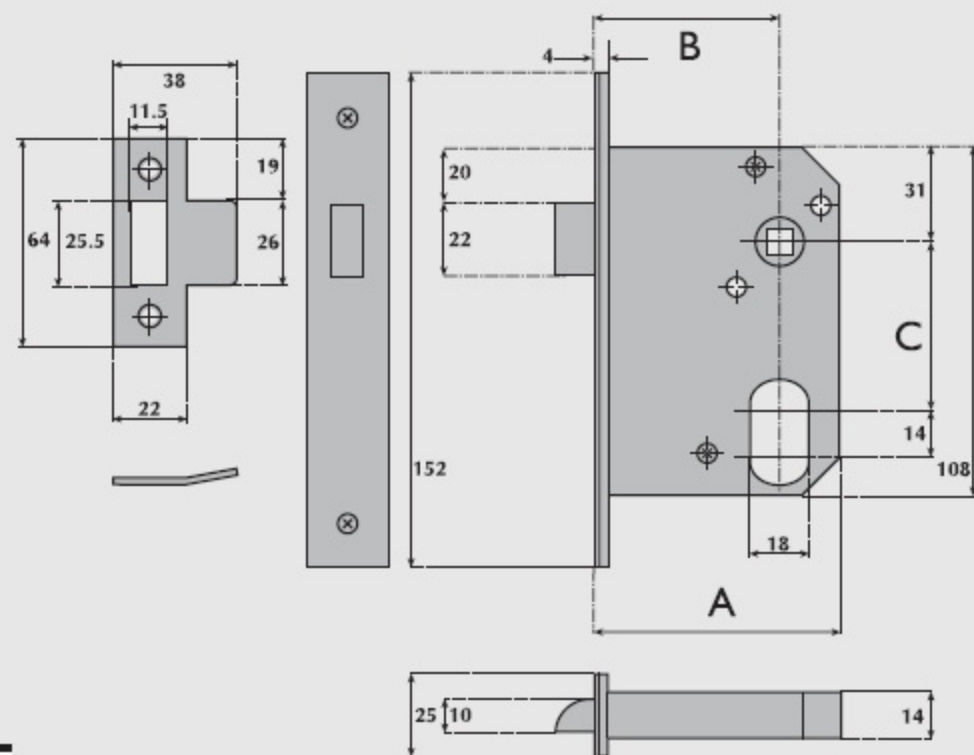

| A Lockcase | B Backset | C Centres |
|------------|-----------|-----------|
| 76mm       | 57mm      | 52mm      |
| 101mm      | 82mm      | 52mm      |

## OPERATION:

Latchbolt operated by key from outside and lever handle or turn knob from inside.

## SPECIFICATION:

### CASE.

Pierced to accept 38mm centre diagonally opposed bolt through fixing furniture.

### STRIKE PLATE.

Type E.

### LATCHBOLT.

Brass. Projection 12mm. Hand must be specified. Also available with non-handed roller bolt.

### FOLLOWER.

Brass, to suit 8mm square spindle. One-way action. Sprung to suit sprung lever handle furniture.

For unsprung lever handle furniture heavy springing should be specified.

### CYLINDER.

Not supplied. May be used with the following cylinder:

- Key outside such as Guardian G9010.
- Key either side such as Guardian G9011.

### REBATE UNITS

### TO SUIT:

G3051-13mm G3052-19mm G3053-25mm