

G4053 Mortice latch

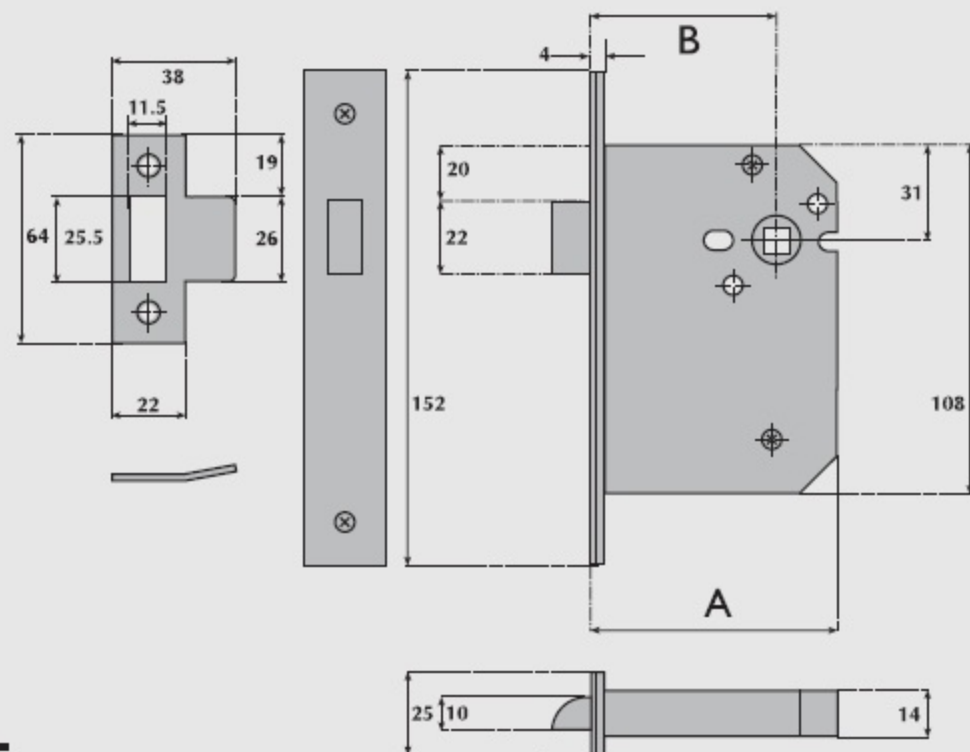

A Lockcase	B Backset	C Centres
63mm	45mm	—
76mm	57mm	—
101mm	82mm	—

OPERATION:

Latchbolt operated by lever handle from either side.

SPECIFICATION:

CASE.

76mm and 101mm sizes pierced to accept 38mm centre horizontally and diagonally opposed bolt through fixing furniture; 63mm size pierced diagonally only.

STRIKE PLATE.

Type E.

LATCHBOLT.

Brass, reversible. Projection 12mm.

FOLLOWER.

Brass, to suit 8mm square spindle. One-way action.

Sprung to suit sprung lever handle furniture.

For unsprung lever handle furniture heavy springing should be specified.

REBATE UNITS

TO SUIT:

G3051-13mm G3052-19mm G3053-25mm